

Symbol	Description
●	4.50 kg MULTI-PURPOSE, TYPE ABC PORTABLE FIRE EXTINGUISHER
●	4.50 kg CARBON DIOXIDE TYPE PORTABLE FIRE EXTINGUISHER
●	50 kg MULTI-PURPOSE, TYPE ABC WHEELIE TYPE FIRE EXTINGUISHER
●	UPRIGHT TYPE SPRINKLER HEAD
●	CONCEALED TYPE SPRINKLER HEAD
▶	SIDE-WALL SPRINKLER 4.8 M, 32 GPM @16.0 PSI
▶	SIDE-WALL SPRINKLER-EXTENDED COVERAGE 5.5 M, 36 GPM @20.3 PSI
▶	SIDE-WALL SPRINKLER-EXTENDED COVERAGE 6.2 M, 40 GPM @25.0 PSI
✕	FM 200 NOZZLES
●	QUICK COUPLER VALVE
■	FIRE HOSE CABINET
■	FIRE DEPARTMENT VALVE (DRY RISER) WITH 630 FIRE HOSE REEL
■	FLOOR CONTROL VALVE ASSEMBLY
■	CLEAN AGENT CYLINDER
■	FIRE ALARM BELL
■	FIRE ALARM HORN
■	CONTROL PANEL
■	ABORT & MANUAL SWITCH

Symbol	Description
—	2000 FIRE WATER MAIN LINE
—	1500 FIRE WATER MAIN LINE
—	FIRE WATER BRANCH LINE TO SPRINKLERS

- NOTES:**
- ALL DIMENSIONS ARE IN MILLIMETERS AND ELEVATIONS IN METER UNLESS OTHERWISE SHOWN.
 - ALL PIPE SIZE SHOWN ARE NOMINAL PIPE DIAMETER IN MILLIMETERS.
 - ALL FIRE PROTECTION INSTALLATIONS SHALL CONFORM WITH NATIONAL FIRE PROTECTION ASSOCIATION (NFPA) AND CIVIL DEFENSE REGULATIONS.
 - FOR 2ND BASEMENT FRAMING PLAN, REFER TO DRAWING NO. 3015102 (REV. D DATED 2010).
 - FOR SCHEDULE OF FOOTINGS, SECTION AND DETAILS, REFER TO DRAWING NO. 3015201 (REV. D).
 - FOR SCHEDULE OF COLUMN REFER TO DRAWING NO. 3015301, 3015302, 3015303 & 3015304.
 - FOR DRAINAGE SYSTEM 2ND BASEMENT (BELOW SLAB) REFER TO DRG. NO. 4P558-HCI-PB-002.
 - FOR WATER SUPPLY SYSTEM 3RD BASEMENT (BELOW SLAB) REFER TO DRG. NO. 4P558-HCI-PB-003.
 - FOR 3RD BASEMENT FLOOR ARCHITECTURAL PLAN (BELOW SLAB) REFER TO DRG. NO. 3014101 (REV. C).
 - FOR 3RD BASEMENT HVAC PLAN REFER TO DRG. NO. 3014101 (REV. C DATED 2010).
 - FOR 3RD BASEMENT LIGHTING PLAN REFER TO DRG. NO. 3014101 (REV. C DATED 2010).
 - FOR 3RD BASEMENT FIRE ALARM & VOICE EVAC SYSTEM PLAN REFER TO DRG. NO. 3014101 (REV. C DATED 2010).
 - FOR SCHEDULE OF FIRE PUMPS AND CAPACITIES REFER TO PUMP ROOM DETAIL DRAWINGS (WILL BE SUBMITTED LATER).
 - ALL FIRE PROTECTION ACCESSORIES AND EQUIPMENTS SHOWN ON THIS DRAWING WILL BE AS PER APPROVED MATERIAL SUBMITTALS.
 - PUMPS AND FIRE TANK ROOM DETAILED DRAWINGS WILL BE SUBMITTED FOR APPROVAL AFTER THE APPROVAL OF MATERIAL SUBMITTAL OF FIRE PUMPS AND ALL RELATED EQUIPMENTS (WILL BE SUBMITTED LATER).
 - FOR SCHEDULE OF FIRE PUMPS AND CAPACITIES REFER TO PUMP ROOM DETAIL DRAWINGS (WILL BE SUBMITTED LATER).
 - DETAILS OF FIC WILL BE PROVIDED AFTER THE APPROVAL OF MATERIAL SUBMITTAL.
 - DETAILS OF FIC WILL BE PROVIDED AFTER THE APPROVAL OF MATERIAL SUBMITTAL.
 - DETAILS OF PVV, GVSS & FS WILL BE PROVIDED AFTER THE APPROVAL OF MATERIAL SUBMITTAL.

SYMBOLS

■	TEE W/ GROOVED END	■	REDUCER
■	90° ELBOW W/ GROOVED END	■	GATE VALVE
■	45° ELBOW W/ GROOVED END	■	RISER NIPPLE (PLAN VIEW)
■	90° LONG RADIUS BEND	■	

LEGENDS:

—	2000 FIRE WATER MAIN LINE
—	1500 FIRE WATER MAIN LINE
—	FIRE WATER BRANCH LINE TO SPRINKLERS

ABBREVIATIONS:

CLD	CEILING	ST	STRAINER
CV	CHECK VALVE	IE	INVERT ELEVATION
DN	DOWN	IN	INLET
FC	FLEXIBLE CONNECTION	IV	ISOLATION VALVE
FACV	FIRE ALARM CHECK VALVE	INTS	NOT TO SCALE
FCEVA	FLOOR CONTROL VALVE ASSEMBLY	PFE	POTABLE FIRE EXTINGUISHER
FDE	FIRE DEPARTMENT VALVE	QCV	QUICK COUPLER VALVE
FHC	FIRE HOSE CABINET	RCV	REMOTE CONTROL VALVE
FHS	FIRE HOSE STATION	RN	RISER NIPPLE
FNL	FIRE WATER NIPPLE	STB	STAIRWELL
FWR	FIRE WATER RISER	TYP.	TYPICAL
FS	FLOW SWITCH	W	WITH
FWAC	FIRE WATER @ CEILING	+	INCH
FWDP	FIRE WATER DOWNHEAD	Ø	DIAMETER
GV	GATE VALVE	AND	
GVSS	GATE VALVE W/ SUPERVISORY SWITCH	°C	DEGREES CENTIGRADE
PS	PRESSURE GAUGE	@	AT
PRV	PRESSURE REDUCING VALVE	B.O.P	BOTTOM OF PIPE

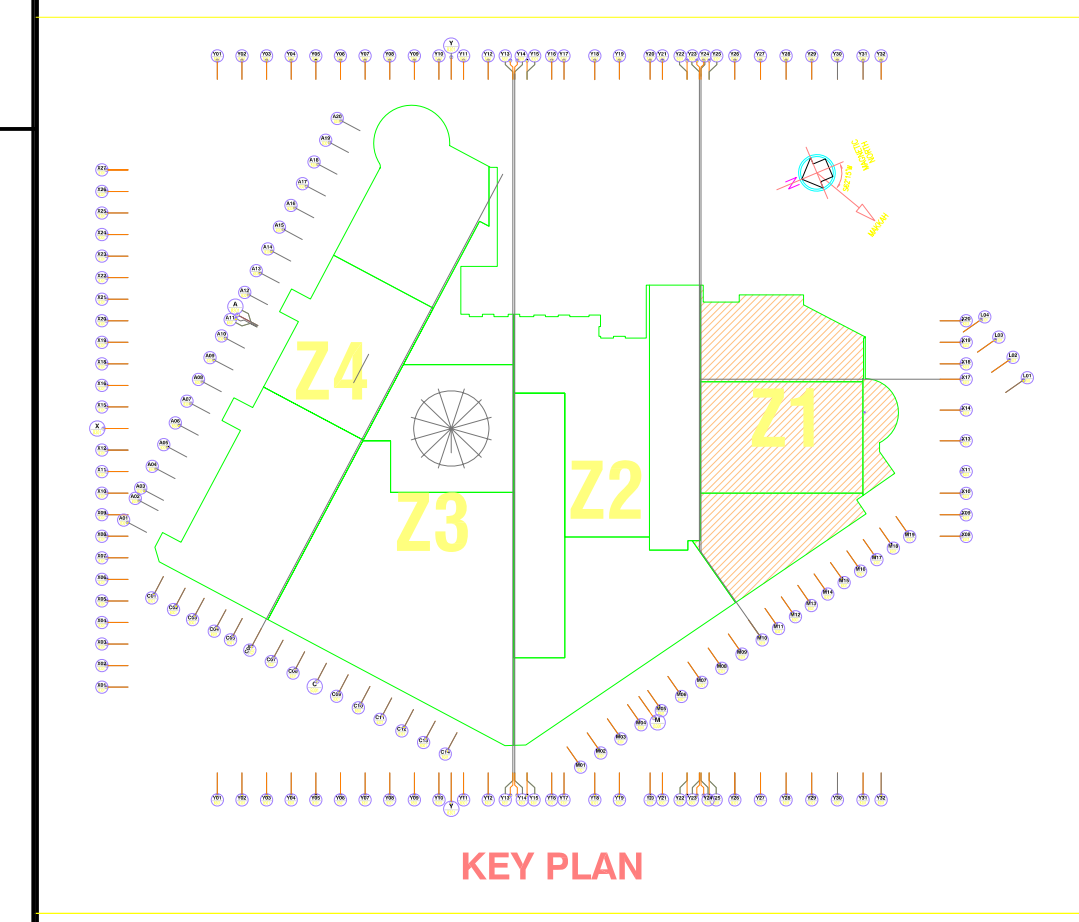

REFERENCE DRAWINGS

REFERENCE DRAWING NO.	DRAWING DESCRIPTION
3015102	2ND BASEMENT FRAMING PLAN (REV. D DATED JAN. 2010)
3014101	3RD BASEMENT FLOOR PLAN (REV. C DATED JAN. 2010)
301FP201	3RD BASEMENT FIRE PROTECTION PLAN (REV. C DATED JAN. 2010)

COORDINATION

NO.	DATE	DESCRIPTION OF CHANGES	DRAWN	CHKD.	APPR.
01	25/03/2009	REVISED AS PER CONSULTANT'S COMMENTS			
02	10/03/2009	SHOP DRAWING ISSUED FOR APPROVAL			

PROJECT TITLE
INFORMATION TECHNOLOGY AND COMMUNICATION COMPLEX CONVENTION HOTEL, PACKAGE-II RIYADH - KINGDOM OF SAUDI ARABIA

CLIENT
Rayadad Investment Company
 P.O. Box: 348550, Riyadh: 11544
 Tel: 01-2059911, Fax: 01-2059922
 E-mail: info@raid.com.sa

DESIGN/CONSULTANT
HanniParsons Co.Ltd.
 9th Fl. City Air Tower Bldg,
 159-9, Somjungsang-Kangnam-gu
 Seoul Korea 135-973
 Tel: 822-3429-6352
 Fax: 822-3429-6353/4
 WWW: hanniparsons.com

MAIN CONTRACTOR
CONTRACTING & CONSTRUCTION ENTERPRISES LTD.
 P.O. Box: 250991
 Riyadh: 11391
 Kingdom of Saudi Arabia
 Tel: (01) 416-1122, 464-2991, Fax: (01) 416-1988,
 Email: info@ccce.com.sa

DESIGNING TITLE
FIRE PROTECTION PIPING LAYOUT 3RD BASEMENT PARTIAL FLOOR-ZONE 1

Drawing Type	Drawing No.	Shr. No.	Rev. No.
FIRE PROTECTION	PC59-HCI-1-FP-001	02	01

Scale: AS SHOWN
 Drawn By: K.R.
 Checked By: K.H.
 Signature: _____
 Date: 25/03/2010