

POTABLE AND FIRE WATER TANK
(REFER TO DWG. NO. PB59-HC1-CCE-PB-001)

POTABLE AND FIRE WATER PUMP ROOM
3RD BASEMENT PARTIAL PLAN
SCALE = 1:20

MARK	QTY.	LOCATION	DESCRIPTION	TYPE	EQUIPMENT RATING (EACH)				ELECTRICAL DATA			REMARKS
					CAPACITY	TRN	MOTOR	VOLTS	PHASE	HEZT		
(1)	1	PUMP ROOM @ BASEMENT 3	FIRE PROTECTION PUMPING LINE	ELECTRICAL	1000	47	112	150	380	3	60	DUTY
(2)	1	PUMP ROOM @ BASEMENT 3	FIRE PROTECTION PUMPING LINE	DIESEL	1000	47	112	-	-	-	60	DESIGNED BY AS RECOMMENDED BY DIESEL MANUFACTURER.
(3)	1	PUMP ROOM @ BASEMENT 3	FIRE PROTECTION PUMPING LINE	JOCKEY	50	3.2	150	7.5	380	3	60	
(4)	3	PUMP ROOM @ BASEMENT 3	DIELECTRIC WATER BOOSTER PUMP (POTABLE WATER)	VERTICAL IN-LINE CENTRIFUGAL PUMP	-	15.77	7.5	20	380	3	60	2 DUTY 1 STANDBY VARIABLE SPEED PUMP INCLUDING CONTROL PANEL.
(5)	2	PUMP ROOM @ BASEMENT 3	CARTRIDGE FILTER	-	-	15.77 (EACH)	-	-	-	-	-	
(6)	2	PUMP ROOM @ BASEMENT 3	HEAT EXCHANGER	-	-	-	-	-	-	-	-	CAPACITY = 1600 KW/KWH PUMP ROOM @ BASEMENT 3 DUTY 1 STANDBY
(7)	1	PUMP ROOM @ BASEMENT 3	PRESSURE VESSEL	-	-	-	-	-	-	-	-	CAPACITY = 500 LITERS

- NOTES:**
- ALL DIMENSIONS ARE IN MILLIMETERS AND ELEVATIONS IN METER UNLESS OTHERWISE SHOWN.
 - ALL PIPE SIZE SHOWN ARE NOMINAL PIPE DIAMETER IN MILLIMETERS.
 - THIS DRAWING MUST BE READ IN CONJUNCTION WITH THE APPROVED STRUCTURAL AND ARCHITECTURAL DRAWINGS.
 - ALL SLEEVES SHALL BE PACK BY FIRE RATED SEALANT.
 - ELEVATION OF ALL PIPES ARE GIVEN IN FINISH FLOOR LEVEL.
 - FOR POTABLE AND FIRE WATER TANK PIPING LAYOUT REFER TO DWG. NO. PB59-HC1-CCE-PB-001
- ABBREVIATIONS:**
- | | | | |
|-------|-----------------------|------|---------------------------|
| B.O.P | BOTTOM OF PIPE | SPDR | SEWER PIPE DRAINAGE RISER |
| BF | BLIND FLANGE | SPDL | SEWER PIPE DRAINAGE LINE |
| CLG | CEILING | TYP | TYPICAL |
| CO | CLEANOUT | UG | UNDER GROUND |
| CV | CHECK VALVE | VS | VENT STACK |
| CP | CRACK PIPE | VP | VENT PIPE |
| EL | ELEVATION | W | WITH |
| FWL | FIRE WATER | Ø | DIAMETER |
| FC | FLEXIBLE CONNECTOR | & | AND |
| GV | GATE VALVE | ↗ | TO ABOVE |
| IE | INVERT ELEVATION | ↖ | FLOW DIRECTION |
| PS | PRESSURE GAUGE | ↗ | TO ABOVE |
| PRV | PRESSURE RELIEF VALVE | ↖ | TO BELOW |
| PS | PRESSURE SWITCH | ↗ | FROM BELOW |
| PW | POTABLE WATER | ↖ | FROM ABOVE |

ITEM NO.	MATERIAL SCHEDULE	MATERIAL
01	PIPES FOR FIRE WATER AND POTABLE WATER LINE INSIDE PUMP ROOM	CALSHIPPED STEEL ASTM A53 TYPE E, GRADE A OR B, SCH. 40 ROLL GROOVED ENDS
02	THREADS FITTINGS FOR 50mm DIA. AND SMALLER (FOR FIRE WATER)	DUCTILE IRON ASTM A536
03	GROOVED END FIT OR FLANGED FOR 65mm DIA. AND ABOVE	DUCTILE IRON ASTM A536
04	PIPES AND FITTINGS FOR DRAIN LINE	UPVC

ITEM NO.	ACCESSORIES AND FITTINGS	DESCRIPTION
01	FIRE PUMP (ELECTRICAL DRIVEN)	
02	FIRE PUMP (DIESEL DRIVEN)	
03	JOCKEY PUMP	
04	PACKAGE TYPE WATER PUMP	
05	GATE VALVE	
06	CHECK VALVE	
07	OS & Y GATE VALVE w/ SUPERIMPOSED SWITCH	
08	PRESSURE RELIEF VALVE	
09	PRESSURE GAUGE	
10	FLOW METER	
11	45° ELBOW	
12	90° ELBOW	
13	STRAIGHT TEE	
14	REDUCING TEE	
15	STRAINER	
16	PIPE SLEEVE	
17	FLEXIBLE CONNECTION OR JOINT	
18	REDUCER	
19	FLANGES BLIND END - ON LAP JOINT	
20	BUTTERFLY VALVE (LEVER OPERATED)	
21	CARTRIDGE FILTER	
22	HEAT EXCHANGER	
23	CONTROL PANEL FOR JOCKEY PUMP	
24	CONTROL PANEL FOR DIESEL DRIVEN FIRE PUMP	
25	CONTROL PANEL FOR ELECTRIC DRIVEN FIRE PUMP	
26	CONTROL PANEL FOR PACKAGE WATER PUMP	
27	PIRE SUPPURT	
28	DIESEL ENGINE MUFFLER	
29	ALARM CHECK VALVE w/ RETARD CHAMBER	
30	300 x 500mm TRENCH PIT w/ GRATING COVER	

NOTE: ALL EQUIPMENTS, PIPES, ACCESSORIES AND FITTINGS SHALL BE AS PER REQUIRED SIZE, SPECIFICATIONS, AND APPROVED MATERIAL SUBMITTAL.

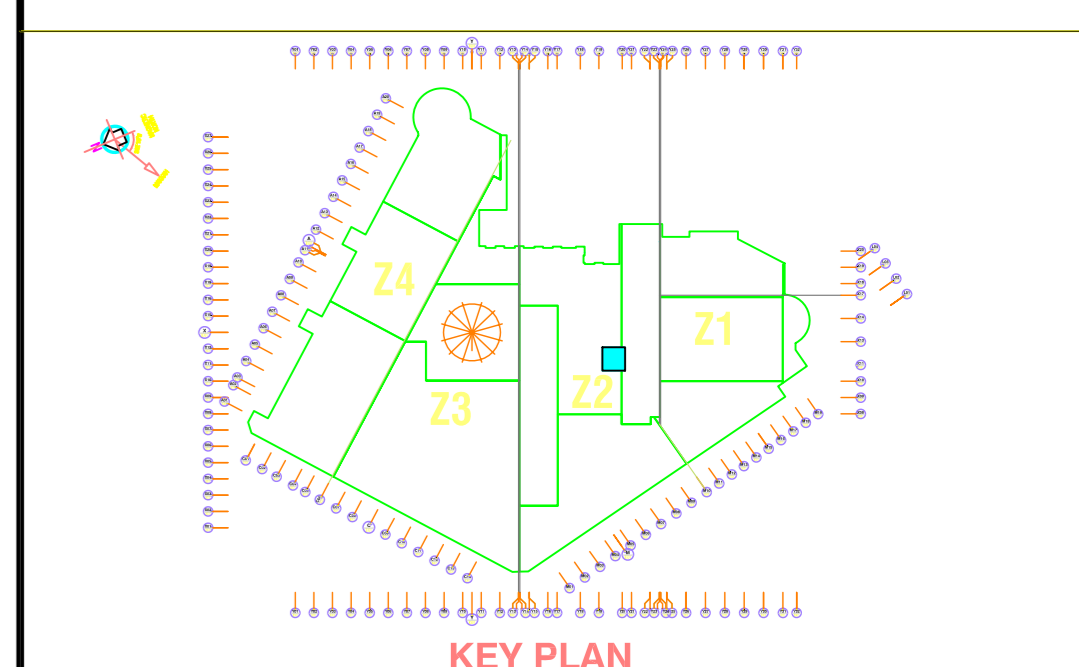

REFERENCE DRAWING NO.	DRAWING DESCRIPTION
301FP201	3RD BASEMENT FIRE PROTECTION PLAN
301S101	3RD BASEMENT FOUNDATION PLAN
301FP101	3RD BASEMENT FLOOR PLUMBING PLAN

Rev. No.	Date	Description of Changes	Draw	Chkd.	Appr.
00	06/07/2010	ISSUED FOR APPROVAL			

PROJECT TITLE
INFORMATION TECHNOLOGY AND COMMUNICATION COMPLEX CONVENTION HOTEL, PACKAGE-II RIYADH - KINGDOM OF SAUDI ARABIA

CLIENT
Rayadah Investment Company
Post Box: 56850, Riyadh: 11564
Tel: 01-2059911, Fax: 01-2059922
E-mail: info@raid.com.sa

PROJECT MANAGER
HanmiParsons Co.Ltd.
9th Fl. City Air Tower Bldg.
150-29, Samsung-dong, Kangnam-gu
Seoul Korea 135-873
Tel: 822-3429-6352
Fax: 822-3429-6363/4
WWW: hanmiparsons.com

DESIGN/CONSULTANT
CCE
Contracting & Construction Enterprises Ltd.
Riyadh 11391
Kingdom of Saudi Arabia
Tel: (01) 416-1122, 464-2991, Fax: (01) 416-1986,
Email: cce@ccesaudi.com

MAIN CONTRACTOR
CONTRACTING & CONSTRUCTION ENTERPRISES LTD.
P.O.Box. 250991
Riyadh 11391
Kingdom of Saudi Arabia
Tel:(01) 416-1122, 464-2991, Fax:(01) 416-1986,
Email: cce@ccesaudi.com

DRAWING TITLE
POTABLE AND FIRE WATER PUMP ROOM PIPING AND EQUIPMENT LAYOUT 3RD BASEMENT PARTIAL PLAN

Drawing Type	Drawing No.	Sht. No.	Rev. No.
PLUMBING	PB59-HC1-CCE-PB-002-01	1	00

Scale	Drawn By	Signature	Checked By	Signature
AS SHOWN	K.R.		K.H.	

Drawing Status	Issued For	Date
SHOP DRAWING	APPROVAL	06/07/2010