

PPR PIPE NOMINAL DIA (mm)	ROD DIA (mm)	MAX SPACING (mm)
50 mm AND SMALLER	10	1500
63 mm TO 90 mm	13	1500
100 mm TO 127 mm	16	1500
150 mm TO 200 mm	19	1500

NOTE:
PIPE SUPPORTS WILL BE AS PER APPROVED MATERIAL SUBMITTALS

WATER DISTRIBUTION -PIPING LAYOUT
3RD BASEMENT PARTIAL FLOOR-ZONE 2
SCALE=1:200



- NOTES:**
- ALL DIMENSIONS ARE IN MM UNLESS OTHERWISE SHOWN
 - ALL PIPE SIZE SHOWN ARE NOMINAL PIPE DIAMETER IN MILLIMETERS
 - FOR 2ND BASEMENT FRAMING PLAN REFER TO DRAWING NO. 3015102 (REV D DATED 2010)
 - FOR SCHEDULE OF FOOTINGS, SECTION AND DETAILS REFER TO DRAWING NO. 3015101 (REV D)
 - FOR SCHEDULE OF COLUMN REFER TO DRAWING NO. 3015103, 3015105, 3015106 & 3015104
 - FOR DRAINAGE SYSTEM 2ND BASEMENT (BELOW SLAB) REFER TO DRG. NO. -PDS-HCI-PH-002
 - FOR 3RD BASEMENT FLOOR PLAN REFER TO DRG. NO. 3014181 (REV C DATED 2010)
 - FOR HOT & COLD WATER LINES RISER BUILDING, POLYPROPYLENE PIPES AND FITTINGS WILL BE USED AS PER APPROVED MATERIAL SUBMITTALS
 - FOR WATER PUMPS, POTABLE WATER PUMPS, NON-POTABLE WATER PUMPS, SHAW WATER TREATMENT PLANT EQUIPMENTS AND ALL EQUIPMENTS RELATED TO THESE WILL BE PROVIDED IN DETAIL DRAWING UPON APPROVAL OF MATERIAL SUBMITTALS

ABBREVIATIONS:

CLG	CHECK VALVE	PG	PRESSURE GAUGE
CV	CHECK VALVE	PRV	PRESSURE REDUCING VALVE
DN	DOWN	OCV	OVERFLOW VALVE
FC	FLEXIBLE CONNECTION	RCV	REMOTE CONTROL VALVE
FS	FLOW SWITCH	ST	STRAINER
GM	GATE VALVE	STD	STANDARD
GVSS	GATE VALVE W/ SUPERVISORY SWITCH	TYP	TYPICAL
IE	INVERT ELEVATION	W	WITH
IN	INLET	"	HIGH
IT	ISOLATION VALVE	Ø	DIAMETER
N/S	NOT TO SCALE	&	AND
NPWR	NON-POTABLE WATER RISER	°C	DEGREES CENTIGRADE
NPWAC	NON-POTABLE WATER ABOVE CEILING	@	AT
PWR	POTABLE WATER RISER	B.O.P	BOTTOM OF PIPE
PWLAC	POTABLE WATER LINE ABOVE CEILING		

LEGENDS & SYMBOLS

	1500 POTABLE WATER LINE
	1000 NON-POTABLE WATER LINE
	1000 / 750 MAKE-UP WATER LINE

SYMBOLS

	FUSION THERM ELBOW 90°		FUSION THERM TEE
	FUSION THERM SOCKET		ELBOW 90° BOTTOM VIEW
	GATE VALVE		FLOW DIRECTION

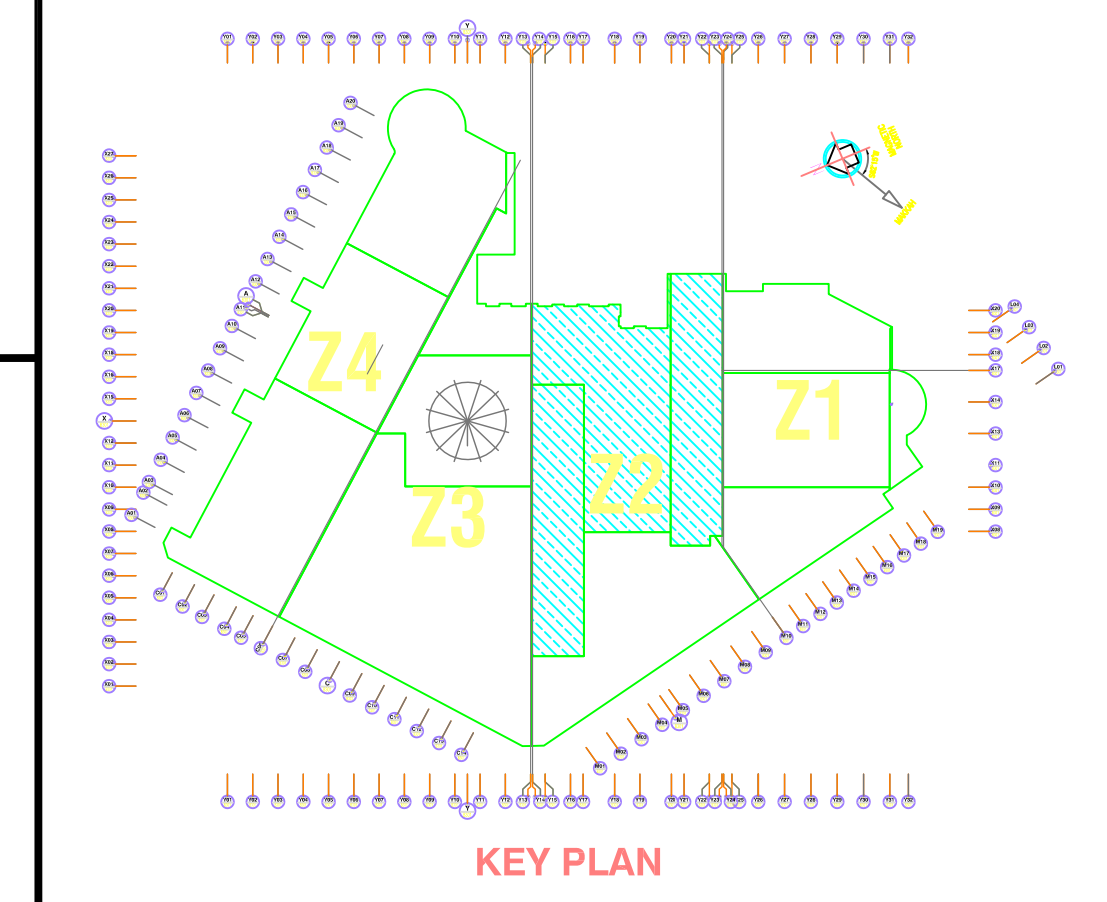

REFERENCE DRAWINGS

REFERENCE DRAWING NO.	DRAWING DESCRIPTION
3014181	3RD BASEMENT FLOOR PLAN (REV D DATED JAN 2010)
3015102	2ND BASEMENT FRAMING PLAN (REV C DATED JAN 2010)
3015103	3RD BASEMENT FRAMING PLAN (REV C DATED JAN 2010)

COORDINATION

DATE	BY	DESCRIPTION

CHANGE LOG

No.	Date	Description of Changes	Drawn	Checked	Approved
01	10/03/2010	ISSUED FOR APPROVAL			

INFORMATION TECHNOLOGY AND COMMUNICATION COMPLEX CONVENTION HOTEL, PACKAGE-II RYADH - KINGDOM OF SAUDI ARABIA

Client: Rayadah Investment Company
 Plot No. 50850, Riyadh 11564
 Tel: 01-2059911, Fax: 01-2059922
 E-mail: info@raid.com.sa

PROJECT MANAGER: HanmiParsons Co.Ltd.
 9th Fl. City Air Tower Bldg,
 152-9, Samsung-Dong, Kangnam-gu,
 Seoul, Korea 155-975
 Tel: 82-2-3429-6352
 Fax: 82-2-3429-6353/4
 WWW: hanmiparsons.com

DESIGN/CONSULTANT: HanmiParsons Co.Ltd.
 9th Fl. City Air Tower Bldg,
 152-9, Samsung-Dong, Kangnam-gu,
 Seoul, Korea 155-975
 Tel: 82-2-3429-6352
 Fax: 82-2-3429-6353/4
 WWW: hanmiparsons.com

MAIN CONTRACTOR: CONTRACTING & CONSTRUCTION ENTERPRISES LTD.
 P.O. Box 20991
 Riyadh 11541
 Kingdom of Saudi Arabia
 Tel: 011 436-1122, 436-3931, Fax: 011 414-1988,
 Email: cce@cceesaudi.com

WATER DISTRIBUTION -PIPING LAYOUT 3RD BASEMENT PARTIAL FLOOR-ZONE 2

Drawing Type	Drawing No.	Sheet No.	Rev. No.
PLUMBING	PC59-HC.1-PB-003	02	00

Scale	Drawn By	Signature	Checked By	Signature
AS SHOWN	KS		HALED HASSAN	

Drawing Status	Issued For	Date
SHOP DRAWING	APPROVAL	10/03/2010