

**LEGENDS & SYMBOLS**

PFE	4.50 kg MULTI-PURPOSE, TYPE ABC PORTABLE FIRE EXTINGUISHER
CO2	4.50 kg CARBON DIOXIDE TYPE PORTABLE FIRE EXTINGUISHER
WFE	50 kg MULTI-PURPOSE, TYPE ABC WHEELED TYPE FIRE EXTINGUISHER
●	PENDENT TYPE SPRINKLER HEAD
○	UPRIGHT TYPE SPRINKLER HEAD
●	CONCEALED TYPE SPRINKLER HEAD
▶	SIDE-WALL SPRINKLER 4.9 M, 32 GPM @16.0 PSI
▶S1	SIDE-WALL SPRINKLER-EXTENDED COVERAGE 5.5 M, 38 GPM @20.3 PSI
▶S2	SIDE-WALL SPRINKLER-EXTENDED COVERAGE 6.2 M, 44 GPM @25.0 PSI
▶S3	SIDE-WALL SPRINKLER-EXTENDED COVERAGE 6.7 M, 44 GPM @30.3 PSI
▶S1	SIDE-WALL SPRINKLER-EXTENDED COVERAGE 7.3 M, 48 GPM @36.0 PSI
⊗	FM 200 NOZZLES
○	QUICK COUPLER VALVE
■	FIRE HOSE CABINET
○	FIRE DEPARTMENT VALVE (DRY RISER) WITH 630 FIRE HOSE REEL
○	FLOOR CONTROL VALVE ASSEMBLY
○	CLEAN AGENT CYLINDER
○	FIRE ALARM BELL
○	FIRE ALARM HORN
○	CONTROL PANEL
○	ABORT & MANUAL SWITCH

- NOTES:**
- ALL DIMENSIONS ARE IN MILLIMETERS AND ELEVATIONS IN METER UNLESS OTHERWISE SHOWN.
  - ALL PIPE SIZE SHOWN ARE NOMINAL PIPE DIAMETER IN MILLIMETERS.
  - ALL FIRE PROTECTION INSTALLATIONS SHALL CONFORM WITH NATIONAL FIRE PROTECTION ASSOCIATION (NFPA) AND CIBI, DEFENSE REGULATIONS.
  - FOR 2ND BASEMENT FRAMING PLAN REFER TO DRAWING NO. 301S102 (REV D DATED 2010).
  - FOR SCHEDULES OF FOOTINGS, SECTIONS AND DETAILS REFER TO DRAWING NO. 301S201 (REV D).
  - FOR SCHEDULES OF COLUMN REFER TO DRAWING NO. 301S301, 301S302, 301S303 & 301S304.
  - FOR DRAINAGE SYSTEM 2ND BASEMENT (BELOW SLAB) REFER TO DRG. NO. 4PC59-HC-195-002.
  - FOR WATER SUPPLY SYSTEM 3RD BASEMENT (BELOW SLAB) REFER TO DRG. NO. 4PC59-HC-195-003.
  - FOR 3RD BASEMENT FLOOR ARCHITECTURAL PLAN REFER TO DRG. NO. 301A101 (REV C).
  - FOR 3RD BASEMENT HVAC PLAN REFER TO DRG. NO. 301M101 (REV C DATED 2010).
  - FOR 3RD BASEMENT LIGHTING PLAN REFER TO DRG. NO. 301E101 (REV C DATED 2010).
  - FOR 3RD BASEMENT FIRE ALARM & VOICE EVAC SYSTEM PLAN REFER TO DRG. NO. 301E401.
  - ALL PIPES SHOWN ON THE DRAWING ARE ERW GALVANIZED PIPES PIPES CONFORM TO ASTM A53M SCH 40 AND FITTINGS GALVANIZED GROOVED AND GALVANIZED THREADED.
  - ALL FIRE PROTECTION ACCESSORIES AND EQUIPMENTS SHOWN ON THIS DRAWING WILL BE AS PER APPROVED MATERIAL SUBMITTALS.
  - PUMPS AND FIRE TANK ROOM DETAILED DRAWINGS WILL BE SUBMITTED FOR APPROVAL AFTER THE APPROVAL OF MATERIAL SUBMITTAL OF FIRE PUMPS AND ALL RELATED EQUIPMENTS (WILL BE SUBMITTED LATER).
  - DETAILS OF 630 FVW FHR WILL BE PROVIDED AFTER THE APPROVAL OF MATERIAL SUBMITTAL.
  - DETAILS OF FHR WILL BE PROVIDED AFTER THE APPROVAL OF MATERIAL SUBMITTAL.
  - DETAILS OF FRY, GYSS & FS WILL BE PROVIDED AFTER THE APPROVAL OF MATERIAL SUBMITTAL.

**SYMBOLS**

○	TEE W/ GROOVED END	○	REDUCER
○	90° ELBOW W/ GROOVED END	○	GATE VALVE
○	45° ELBOW W/ GROOVED END	○	RISER NIPPLE (PLAN VIEW)
○	30° LONG RADIUS BEND		

**LEGENDS:**

—	2000 FIRE WATER MAIN LINE
—	1500 FIRE WATER MAIN LINE
—	FIRE WATER BRANCH LINE TO SPRINKLERS

**ABBREVIATIONS:**

CLS	CLEARANCE	ST	STRAINER
CV	CHECK VALVE	IE	INVERT ELEVATION
DN	DOWN	IN	INLET
FC	FLEXIBLE CONNECTION	IV	ISOLATION VALVE
FACV	FIRE ALARM CHECK VALVE	N/T	NOT TO SCALE
FCAV	FLOOR CONTROL VALVE ASSEMBLY	FE	FIRE EXTINGUISHER
FV	FIRE DEPARTMENT VALVE	QCV	QUICK COUPLER VALVE
FHC	FIRE HOSE CABINET	RCV	REMOTE CONTROL VALVE
FHS	FIRE HOSE STATION	RN	RISER NIPPLE
FNL	FIRE WATER LINE	STD	STANDARD
FWR	FIRE WATER RISER	TYP	TYPICAL
FS	FLOW SWITCH	W/	WITH
FWAC	FIRE WATER ON CEILING	+	INCH
FWDF	FIRE WATER DOWNFEED	Ø	DIAMETER
GV	GATE VALVE	Ø	Ø
GYSS	GATE VALVE W/ SUPERVISORY SWITCH	°C	DEGREES CENTIGRADE
PG	PRESSURE GAUGE	@	AT
PRV	PRESSURE REDUCING VALVE	B.O.P	BOTTOM OF PIPE

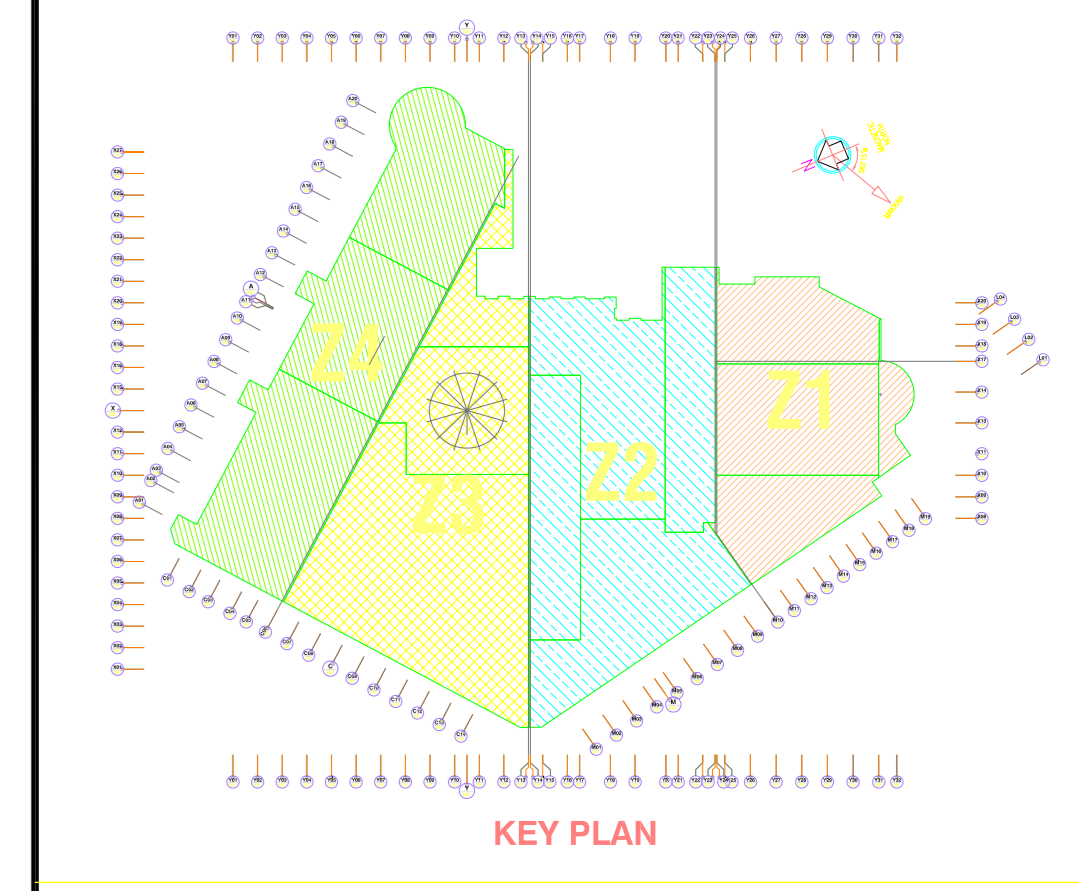

**REFERENCE DRAWINGS**

REFERENCE NO.	DRAWING DESCRIPTION
301S102	2ND BASEMENT FRAMING PLAN (REV D DATED JAN 2010)
301A101	3RD BASEMENT FLOOR PLAN (REV C DATED JAN 2010)
301FP201	3RD BASEMENT FIRE PROTECTION PLAN (REV C DATED JAN 2010)

**COORDINATION**

CONCURRED BY TECHNICAL DEPARTMENT HEAD	
CHECKED: ARCHITECTURAL, STRUCTURAL, ELECTRICAL, MECH, HVAC, PLUMBING, SIRETING, COMMUNICATION, ITC	
SIGNATURE	

Rev. No.	Date	Description of Changes	Draw	Chkd.	Appr.
01	25/03/2010	REVISED AS PER CONSULTANT'S COMMENTS			
02	10/03/2010	SHOP DRAWING ISSUED FOR APPROVAL			

**INFORMATION TECHNOLOGY AND COMMUNICATION COMPLEX CONVENTION HOTEL, PACKAGE-II RIYADH - KINGDOM OF SAUDI ARABIA**

**CLIENT: Rayadah Investment Company**  
 P.O. Box: 518550, Riyadh: 11584  
 Tel: 01-2059911, Fax: 01-2059922  
 E-mail: info@raid.com.sa

**PROJECT MANAGER: HanmiParsons Co.Ltd.**  
 9th Fl. City Air Tower Bldg,  
 159-9, Songmang-dong, Kangnam-gu  
 Seoul Korea 135-973  
 Tel: 822-3429-6552  
 Fax: 822-3429-6363/4  
 WWW: hanmiparsons.com

**DESIGN/CONSULTANT:** [Logo of HanmiParsons Co. Ltd.]

**MAIN CONTRACTOR: CONTRACTING & CONSTRUCTION ENTERPRISES LTD.**  
 P.O. Box: 250991  
 Riyadh 11391  
 Kingdom of Saudi Arabia  
 Tel: (01) 416-1122, 464-2991, Fax: (01) 416-1985,  
 Email: cce@cceksa.com

**DRAWING TITLE: FIRE PROTECTION PIPING LAYOUT 3RD BASEMENT MASTER FLOOR**

Drawing Type	Drawing No.	Shr. No.	Rev. No.
FIRE PROTECTION	PC59-HC.1-FP-001	01	01
Scale	Drawn By	Signature	Checked By
AS SHOWN	K.R.		K.H.
Drawing Status	Issued For	Date	
SHOP DRAWING	APPROVAL	25/03/2010	

**FIRE PROTECTION PIPING LAYOUT 3RD BASEMENT MASTER FLOOR SCALE=1:400**

